

ERUPTING VOLCANO TEACHER GUIDE

Use this Classroom Pack for individual students or groups of students. See the complete line of Classroom Packs at your local educational supply store, hobby shop or online at www.scenearama.com.

Before starting, here are some considerations for your classroom project:

- To better understand this project and the time it takes to complete each session, try building your own Erupting Volcano first.
- The project is divided into four sessions, but modify it for your convenience. Sessions can be combined.
- This kit contains materials that may stain or dry on clothing. Have students bring old clothes or an apron to wear while completing the project.
- Students can extend the paint by dipping their **Paintbrush** in water frequently.
- Students should have flat surfaces to work on. A workspace of approximately 2'x2' should be allotted for each volcano.
- Begin collecting newspapers the week before starting the project.
- The project area should be covered ahead of time with newspapers or table covers (for easy cleanup).

Here are some good ideas:

- Watch the how-to video for this project at www.scenearama.com.
- This kit can be easily adapted for sharing supplies in larger groups working around one table.
- Ask some of your students' parents to volunteer to help during the project.
- Have the students read their guides first before doing their project, so they can see how the project will go together (each step of the **Teacher Guide** corresponds with the **Student Guide**).

After the project has ended, make copies of the Erupting Volcano Certificate (inside back cover) and fill in students' name. It gives them a reminder of the work they have accomplished and the lessons they have learned.

ERUPTING VOLCANO KIT CONTENTS



12 Project Bases* with Labels



Teacher and Student Guide



Rock and Black Colors†

Earth Undercoat†

Project Glue†

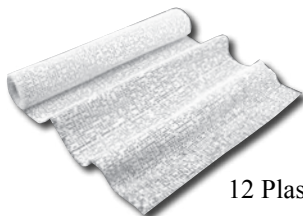

12 Plaster Cloth Rolls†



12 Cardboard Pads



12 Volcano Tubes



12 Foam Brushes



Medium Green Coarse Accent

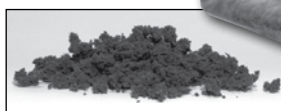

Dark Green Underbrush



36 Plastic Cups
12 Sifter Lids



Eruption Mixture Part A and Part B†

†Non-Toxic. We recommend you do not apply Plaster Cloth directly to skin as it may cause irritation.
*Patent Pending (Base)

Conforms to Health Requirements of ASTM D4236
Made in USA of US and Imported Parts

Kit contents are highlighted in text for easy identification.

ADDITIONAL SUPPLIES

- Water (approx. 5 cups per volcano)
- Newspapers (eight full-sized sheets per volcano)
- Masking Tape (approx. 9' per volcano)
- Scissors (one per volcano)
- Markers (for labeling)
- Paper Towel Rolls for cleanup (2)
- Table Covering (can be newspapers)
- Measuring Cup (1/4 cup)
- Measuring Spoons (1 tablespoon, 1 teaspoon, 1/2 teaspoon, 1/4 teaspoon)
- Paper for funnel (index cards work well)
- Disposable Cup with water (for rinsing **Foam Brushes**)

CREATE VOLCANO SHAPE



Allow approximately 60 minutes.

CONTENTS

QUANTITIES PER VOLCANO

- 1 Cardboard Pad



- 1 Volcano Tube



ADDITIONAL SUPPLIES

- Newspapers (eight full-sized sheets per volcano)
- Masking Tape (approx. 9' per volcano)
- Markers

PREP WORK

- Have students write their names on bottom (middle) of **Cardboard Pad** with marker.
- Distribute eight full-sized sheets of newspaper per volcano.

INSTRUCTIONS

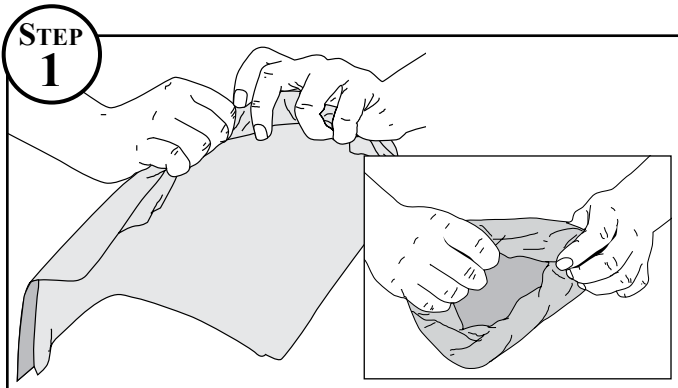

Using a full-sized sheet of newspaper, folded in half, wad by rolling edges under and toward the middle (inset), creating a smooth outer surface. Make four wads.

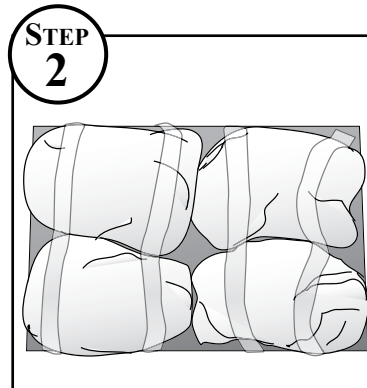

Place the four paper wads on **Cardboard Pad**. Tape to hold. Leave a small space in center for **Volcano Tube**.

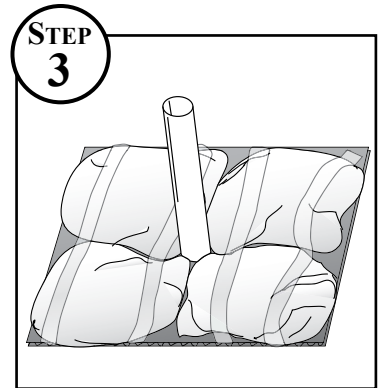

Place **Volcano Tube** in center, but do not tape it down. It will be removed later for cleaning. The paper wads hold the **Volcano Tube** vertically.

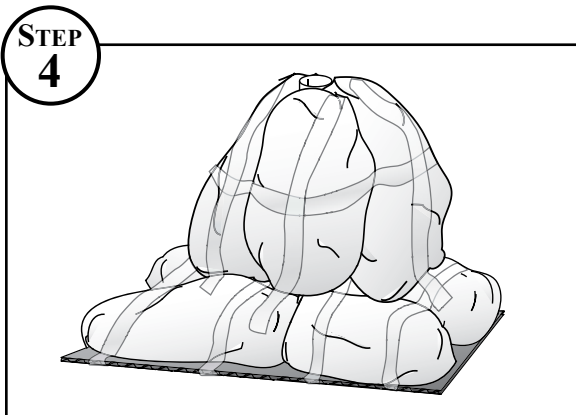

Using a full-sized sheet of newspaper, wad sheet as indicated in Step 1 inset. Make three wads. Stand these wads on end around the **Volcano Tube**, but not taller than the **Volcano Tube** or wider than the **Cardboard Pad**. Tape to hold. Tear smaller pieces of newspaper then wad to fill in any holes. Tape to hold.

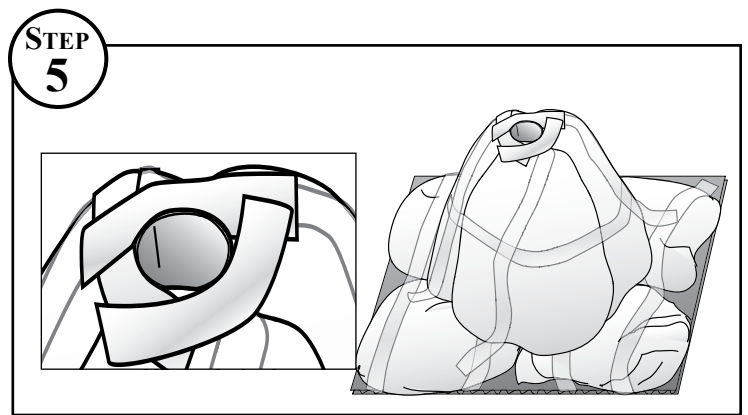

Use tape to seal gaps between paper wads and **Volcano Tube**. DO NOT tape the **Volcano Tube**.

CREATE TERRAIN

Allow approximately 60 minutes.

CONTENTS



• 1 Project Base

QUANTITIES PER VOLCANO

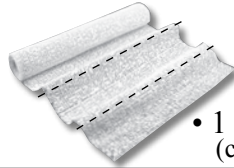

• 1 roll Plaster Cloth
(cut into 3" strips)

ADDITIONAL SUPPLIES

- Scissors (one per volcano)
- Water (five cups per volcano)

PREP WORK

- Cut **Plaster Cloth** into approximately 3" x 8" strips. Be sure to keep the **Plaster Cloth** dry until use.
- Put 1" of water (approximately five cups) in **Project Bases**.

NOTE: When finished with water in Session 2, let sediment from **Plaster Cloth** settle. Pour water off and throw sediment in a trash can.

INSTRUCTIONS

STEP 6

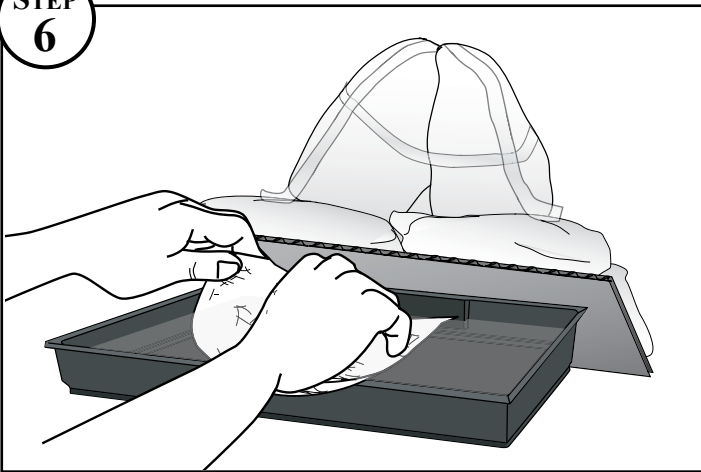

Prop diorama up onto the edge of the water pan. Hold **Plaster Cloth** strip tightly by corners and drag through water.

STEP 7

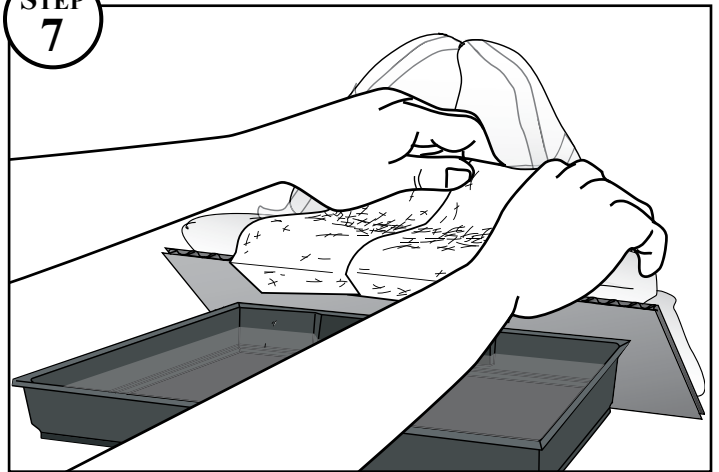

Lay **Plaster Cloth** across the bottom portion of the mountain, bumpy-side-up. Wrap **Plaster Cloth** under the diorama by 1/2 inch and smooth with wet fingers to fill holes.

STEP 8

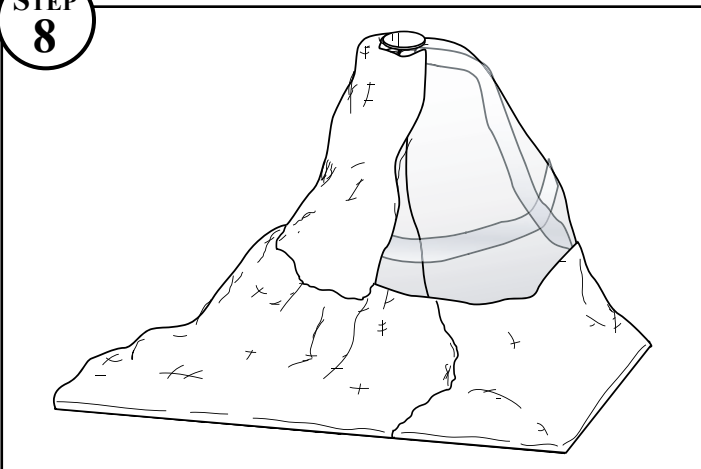

Working toward the top, overlap each strip by 50% until diorama is covered (two layers all over). Place **Plaster Cloth** to top of volcano but not inside **Volcano Tube**.

STEP 9

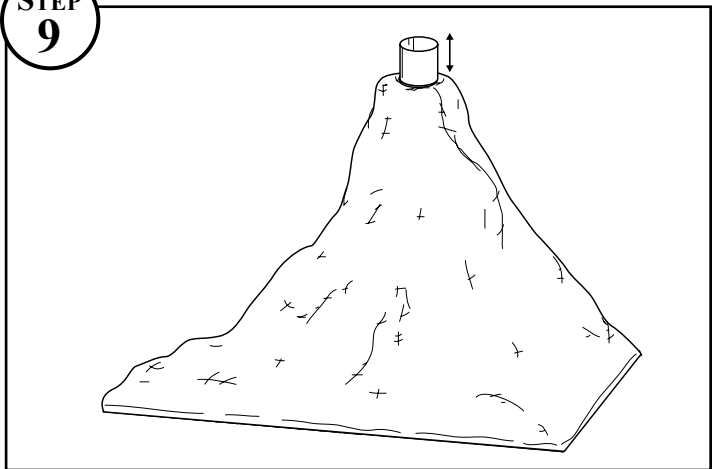

Slide **Volcano Tube** up and down to make sure it will come out later for cleanup. Dry diorama overnight.

LANDSCAPE

Allow approximately 60 minutes.

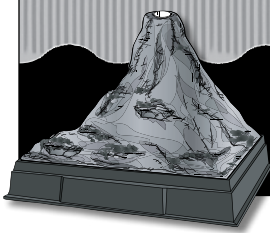

CONTENTS

- 3 Plastic Cups, 1 Sifter Lid and 1 Foam Brush



- 1/4 cup Medium Green Coarse Accent
- 1/4 cup Dark Green Underbrush



QUANTITIES PER VOLCANO

- 1 tbsp Project Glue



- 1 tbsp and 3/4 tsp Earth Undercoat



- 1 1/2 tps Rock and Black Color



ADDITIONAL SUPPLIES

- Measuring Spoons (1tbsp, 1 tsp, 1/2 tsp and 1/4 tsp)
- Measuring Cup (1/4 cup)
- Disposable cup with water (for rinsing Foam Brushes)

PREP WORK

- Put 1 tbsp and 3/4 tsp of **Earth Undercoat** in a **Plastic Cup** (per volcano).
- Put 1 1/2 tps of **Rock Color** in a **Plastic Cup** (per volcano).
- Put 1 1/2 tps of **Black Color** in a **Plastic Cup** (per volcano).

INSTRUCTIONS



STEP 10
Dab **Rock Color** randomly over entire volcano leaving some areas white. Any runs from the color will blend naturally. Rinse **Foam Brush**.



STEP 11
Dab **Earth Undercoat** randomly over entire volcano. This color can overlap the **Rock Color**. Rinse **Foam Brush**.

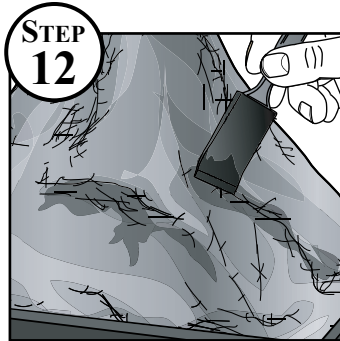

STEP 12
Brush entire volcano with **Black Color** to cover all remaining white areas. This will tie colors together. Rinse **Foam Brush**. Wash and dry **Plastic Cups** before Step 13.



STEP 13
Each volcano needs 1 tbsp glue in a **Plastic Cup** and 1/4 cup of **Dark Green Underbrush** in another **Plastic Cup**. Apply glue where you want **Underbrush** (save some glue for Step 15). Rinse **Foam Brush**.

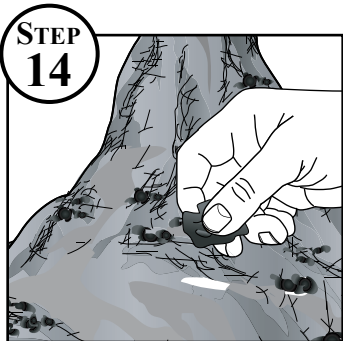

STEP 14
Press **Underbrush** into glue. **NOTE: Dark Green Underbrush** looks best in natural clusters, not in rows.



STEP 15
Add 2 tps of water to remaining glue in **Plastic Cup** and mix well. Brush diluted glue where **Medium Green Coarse Accent** will go. Rinse and dry **Foam Brush** and **Plastic Cup**.

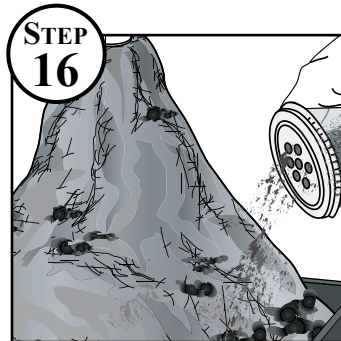

STEP 16
Put 1/4 cup of **Medium Green Coarse Accent** in a **Plastic Cup** with a **Sifter Lid**, then sprinkle **Accent** on top of diluted glue.

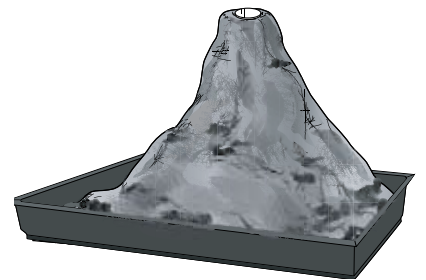

Dry diorama overnight.

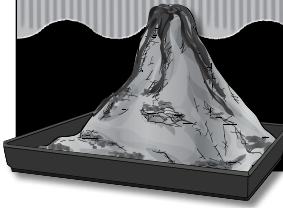

ERUPT

Allow approximately 30 minutes.

CONTENTS

QUANTITIES PER VOLCANO



- 1 Project Base and Label



- 2 Plastic Cups



- 1 tsp Eruption Mixture Part A



- 2 tbsps Eruption Mixture Part B

ADDITIONAL SUPPLIES

- Measuring Spoons (1 tbsp and 1 tsp)
- Paper Towels
- Markers (for labels)
- Water (for cleanup)
- Paper for funnel (index cards work well)

PREP WORK

- Put 1 tsp of **Eruption Mixture A** in a **Plastic Cup** (per volcano).
- Put 2 tbsps of **Eruption Mixture B** in a **Plastic Cup** (per volcano).

NOTE: Consider having students come to front of class to erupt volcanoes. This part of the project would make a great demonstration for other classrooms. You could take photos of this event.

INSTRUCTIONS

STEP 17

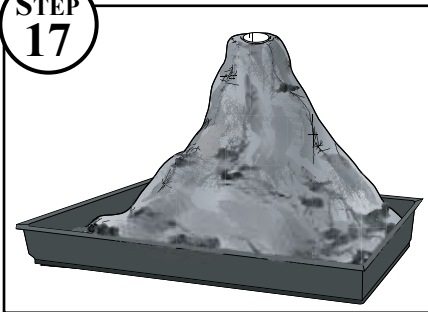

Set volcano in the inverted **Project Base** to catch lava flow. Make sure the **Volcano Tube** is all the way down to the base.

STEP 18



Have students pour all of **Eruption Mixture A** into the **Volcano Tube**. **NOTE:** A paper funnel works great for pouring **Mixture A** into the tube.

STEP 19



Have students pour **Eruption Mixture B** (a little at a time) into the **Volcano Tube** to see the eruption!

STEP 20

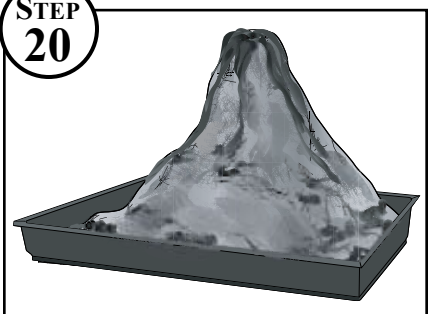

After eruption, rinse **Volcano Tube** and **Project Base**. Dry **Project Base** well so you can label it.

STEP 21

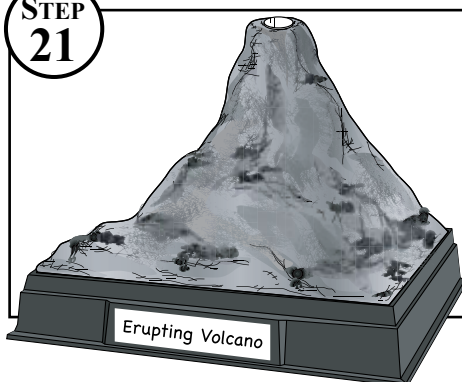

Decorate **Project Label**, on shiny side, with markers and attach it to the front of the **Project Base**.

Eruption Mixture Recipe

- Pour one teaspoon of baking soda into your **Volcano Tube**.
- In a small glass container, mix 2-4 drops of dish soap, 2 tablespoons of vinegar, 6 drops of red food color and 6 drops of yellow food color.
- Pour the mixture into the soda (a little at a time) and watch it erupt! Add the mixture until it doesn't bubble anymore.

NOTE: The Student Guide has this information for making more eruptions.

Scene-A-Rama Class Project

CERTIFICATE OF COMPLETION

This is to certify that

_____ *Name of student*

completed the Scene-A-Rama classroom project

ERUPTING VOLCANO

On _____

Date

_____ *Teacher*

A division of Woodland Scenics®

SCENE+ARAMA

DIORAMAS • SCHOOL PROJECTS • DISPLAYS

See the complete line of products and exciting how-to videos at www.scenearama.com.